

# Plexo composable plate supports and boxes

Cat. No(s) : 696 51/56/61/68/72/78/79/80/81/83/85/87/89  
696 90/91/92/94/96/98

CONTENTS	Page
1. Technical characteristics	1
2. Range	1
3. Installation	1-2-3
4. Dimensions	3
5. General characteristics	4
6. Maintenance	4
7. Specific uses	5
8. Equipment and accessories	5
9. Compliance and approvals	5

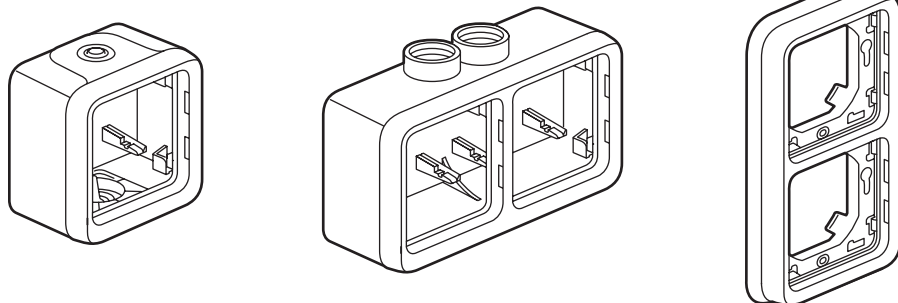

## 1. TECHNICAL CHARACTERISTICS

Weatherproof wiring device system designed for residential and professional technical locations (garages, cellars, car parks, workshops and industrial kitchens, etc) as well as for outdoor applications (patios, gardens, camp sites, etc).

Boxes with entry glands or cable glands and supports supplied with plate. Can take composable mechanisms. Boxes supplied with Nylobloc auto 2 conductor connection terminals, for future tap connections.

## 2. RANGE

Description	Commercial Cat. No.	Weight	Cat. Nos.	2 versions : grey and white
COMPOSABLE SURFACE MOUNTING	1 gang 2 entries	696 51 696 89	80 g	695 xx 696 xx Composable
	2 gang horizontal 2 entries	696 72 696 90	132 g	
	2 gang vertical 2 entries	696 61 696 91	132 g	697 xx 698 xx Complete surface mounting Complete flush mounting
	3 gang horizontal 3 entries	696 80	192 g	
	3 gang vertical 2 entries	696 79 <b>AVAILABLE JAN 2008</b>	192 g	
COMPOSABLE FLUSH MOUNTING	1 gang	696 81 696 92	42 g	
	2 gang horizontal	696 83 696 94	70 g	
	2 gang vertical	696 85 696 96	70 g	
	3 gang horizontal	696 87 696 98	96 g	
CABLE GLAND BLOXES	1 gang 1 entry	696 56	56 g	
	2 gang horizontal 2 entries	696 78	140 g	
	2 gang vertical 2 entries	696 68	140 g	

## 3. INSTALLATION

### 3.1 Surface mounting

- By screwing back box onto support using Ø 3 mm - Ø 4 mm max. screws.
- Drilling template available, Cat. No. 695 97 (see page 5).

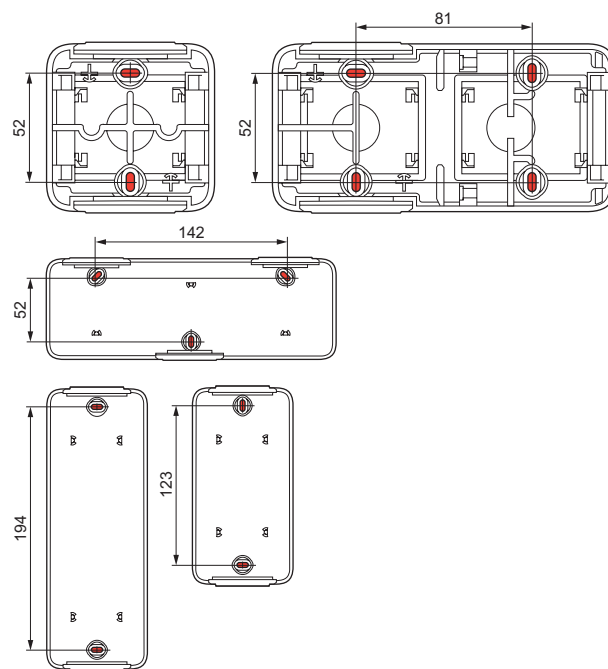

- Replacing former Plexo 55 series.

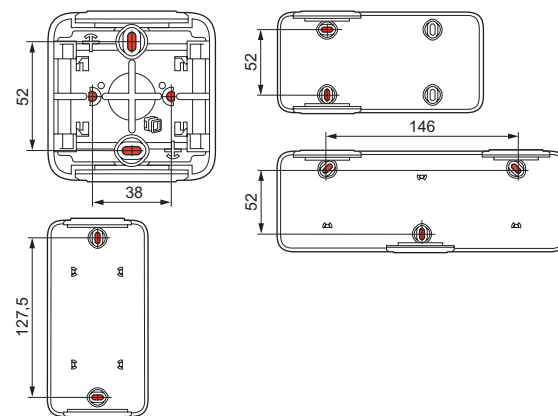

# Plexo composable plate supports and boxes

Cat. No(s) : 696 51/56/61/68/72/78/79/80/81/83/85/87/89  
696 90/91/92/94/96/98

## 3. INSTALLATION (continued)

### 3.2 Flush mounting

- Unclip plate

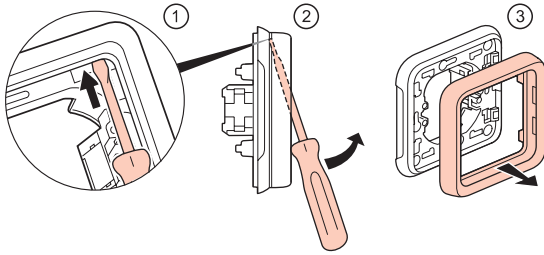

- With screws on flush mounting box  
Use of Batibox™ flush mounting boxes (centre distance 71 mm for multi-gang supports).

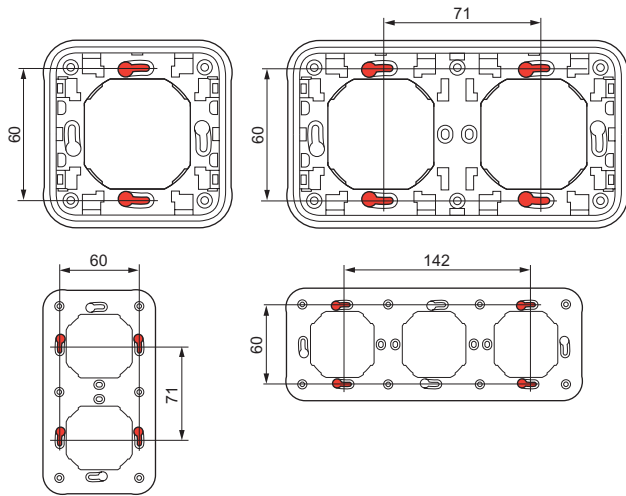

- With claws on flush mounting box

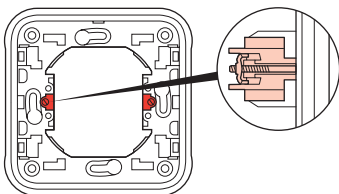

Claws can be fitted :  
Cat. No. 849 00  
or  
Cat. No. 849 01 (long claws)

- On solid faceplate using Ø 4 mm screws. Drill support material (diameter 60 - 70 mm) using hole saw or hole punch.

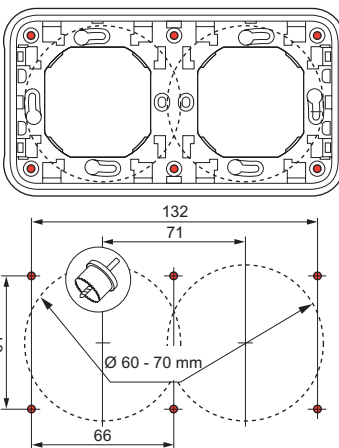

### 3.3 Mounting and sealing

- 2 visible mounting points, centre distance maintained (Plexo 55) except three-gang boxes.
- Fixings are sealed by a gasket overmoulded onto the back of the boxes (except cable gland boxes).
- 2 centre distances maintained :

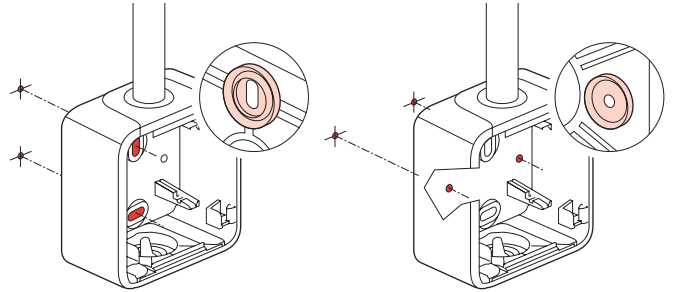

- For cable gland boxes, the covers supplied must be fitted as the boxes have no gasket on the back.

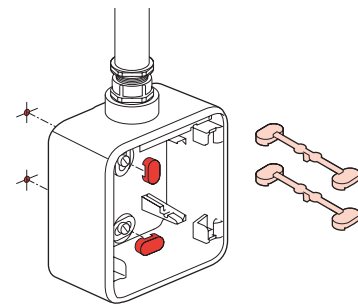

### 3.4 Conduit connection

Type of conduit :

- IRL : formerly IRO, insulating rigid smooth tube
  - ICA : insulating flexible bendable corrugated tube
  - ICTA : insulating flexible transversally bendable elastic corrugated conduit
  - ICTL : insulating flexible transversally bendable elastic smooth conduit
- } Ø 16 - 25 mm

Cables (examples) :

- rigid conductors : U - 1000R2V 3G2.5
- flexible conductors : H07 RN - F 3G2.5

Type of entry gland : flexible with membrane, 2 removable types.

- entry gland with 1 entry supplied with 2 gang and 3 gang boxes (top).
- entry gland with 2 entries supplied with 2 gang and 3 gang boxes (bottom).

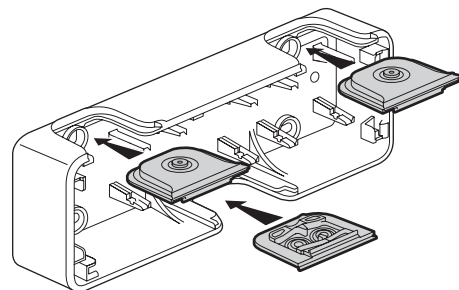

# Plexo composable plate supports and boxes

Cat. No(s) : 696 51/56/61/68/72/78/79/80/81/83/85/87/89  
696 90/91/92/94/96/98

## 3. INSTALLATION (continued)

Ø 4 - Ø 15 mm

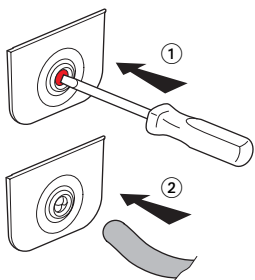

Ø 16/20/25 mm

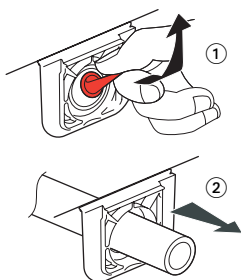

Also available as accessories :  
- 695 96 grey entry gland 1 entry  
- 695 99 grey entry gland 2 entries  
- 696 46 white entry gland 1 entry  
- 696 49 white entry gland 2 entries

### 3.5 Assembly

- Composable motors mounted by clipping into the back of the box.

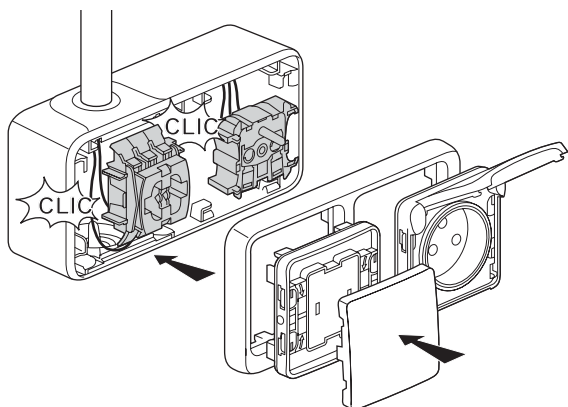

- Removing the partitions from two and three gang boxes facilitates access and allows two and three gang prewired socket mechanisms to be fitted.

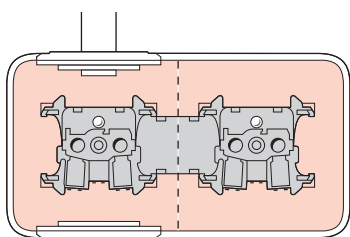

IP55 sealing on front part (cover) on the box is ensured by rotating four 1/4 turn fixings.  
The direction of rotation of each 1/4 turn fixing is shown by an arrow on the cover.

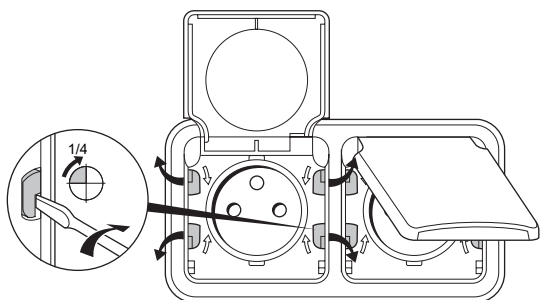

## 4. DIMENSIONS

### Surface mounting

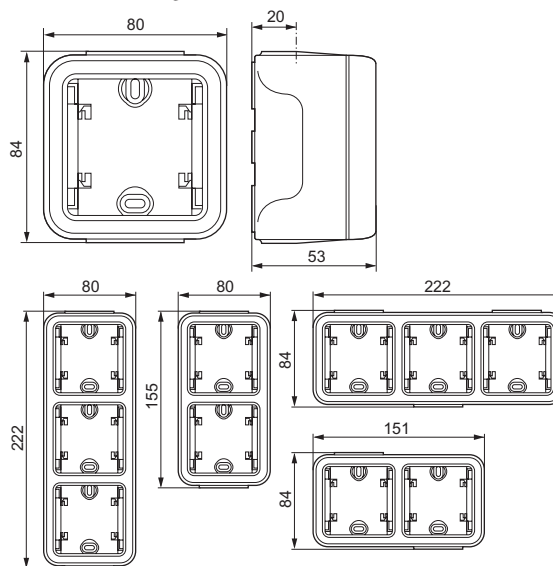

### Flush mounting

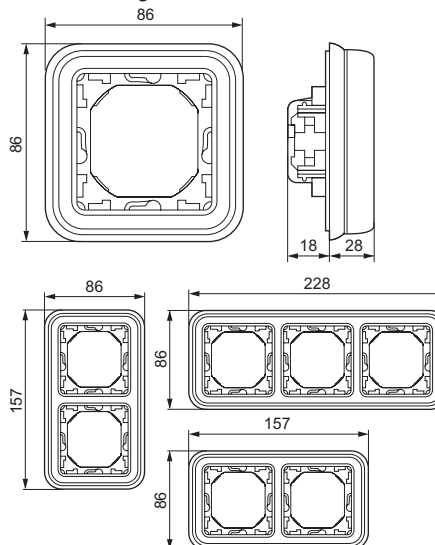

### Surface mounting + cable gland

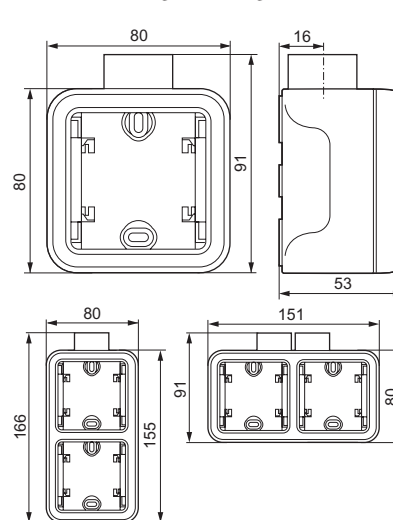

# Plexo composable plate supports and boxes

Cat. No(s) : 696 51/56/61/68/72/78/79/80/81/83/85/87/89  
696 90/91/92/94/96/98

## 5. GENERAL CHARACTERISTICS

### 5.1 Mechanical characteristics

Protection rating :  
- IP 55 IK 07

### 5.2 Material characteristics

#### Materials

Box, support : PP (filled Polypropylene)  
Plate : ABS (Acrylonitrile-Butadiene-Styrene)  
Entry gland : PP + SEBS (Styrene-Ethylene-Butadiene-Styrene)

### 5.3 Resistance to chemicals

	Behaviour
Acetone .....	-
Acetic acid (10%) .....	+
Acetic acid ≥ 30 % .....	+
Aminosulphonic acid .....	-
Boric acid * .....	+
Hydrobromic acid (47%) .....	-
Hydrochloric acid * .....	-
Chromic acid .....	+
Citric acid * .....	+
Hydrofluoric acid * .....	-
Formic acid .....	-
Lactic acid * .....	+
Linoleic acid .....	-
Maleic acid .....	+
Nitric acid (30%) .....	-
Nitric acid (50%) .....	-
Perchloric acid (10%) .....	+
Benzenesulphonic acid .....	-
Phosphoric acid * .....	-
Sulphuric acid .....	+
Tannic acid * .....	-
Tartaric acid * .....	+
Ethanol .....	+
Alcool isopropylique .....	+
Methyl alcohol (methanol) .....	-
Phenylethylalcohol (100%) .....	-
Ammonia .....	+
Baths for electroplating :	
- Bright silver bath .....	+
- Bright cadmium bath .....	+
- Chromium plating bath (50°C) .....	+
- Copper bath (with potassium cyanide) .....	+
- Copper bath (acid) .....	+
- Pickling bath with chemical copper plating .....	+
- Brass bath .....	+
- Bright nickel bath .....	+
Barium	
- Barium chloride * .....	+
- Barium hydroxide * .....	+
- Barium nitrate * .....	-
Benzene .....	-
Beer .....	+
Calcium hypochlorite * .....	+
Cobalt chloride * .....	-
Cupric chloride * .....	-
Ferrous chloride * .....	-
Manganese chloride .....	-
Mercuric chloride * .....	-
Methylene chloride .....	-
Chlorine water (wet gaseous chlorine) .....	-
Sea water .....	+
Fertiliser .....	+
Epichlorohydrin .....	-
Heavy gasoline .....	-
White spirit .....	-
Turpentine .....	-
Essential oils .....	+
Linseed oil .....	+
Lubricating oil .....	+

Machine oil .....	+
Mineral oil .....	+
Paraffin oil .....	+
Fish oil .....	+
Castor oil .....	+
Silicon oil .....	+
Humus .....	+
Aqueous hydrogen sulphide .....	+
Hypochlorite of soda (10%) .....	+
Fruit juice .....	+
Milk .....	+
Chlorinated lye .....	+
Margarine .....	+
Fuel oil .....	+
Mercury .....	+
Methyl methacrylate .....	-
Silver nitrate* .....	+
Cobalt nitrate* .....	+
Manganese nitrate * .....	+
Mercuric nitrate * .....	+
Nickel nitrate* .....	+
Lead nitrate * .....	+
Petroleum, petroleum ether .....	-
Silicate (Potassium, Sodium) .....	+
Syrup (beetroot) .....	+
Sodium	
- Sodium acetate* .....	+
- Sodium bromate* .....	+
- Sodium chloride* (salt) .....	+
Caustic soda ≤ 40 % .....	+
Monomer styrene .....	-
Sugar .....	+
Trichlorethylene .....	-
Urine .....	+
Wine .....	+

\* all concentrations in aqueous solution

#### Key : + resistant - unstable

This information is given as a guide only and can not be construed as an undertaking on the part of the manufacturer.

Please contact us for specific uses.

### 5.4 Resistance to ultraviolet radiation

No notable alteration following the 7 day test with 550 W/m<sup>2</sup> power lighting (Colorimetric measurement using lab method).

### 5.5 Resistance to salt spray : 7 days (168 hrs)

### 5.6 Electrical characteristics

- Self-extinguishing in accordance with IEC 60695-2-11 :  
components (or parts) required to secure live parts : 850°C  
components (or parts) not required to secure live parts : 650°C

- Voltage - Current - Frequency  
16 A 250 V~ 50 Hz in accordance with NF C 61-314, NBN C 61-112  
and IEC 60884-1.

### 5.7 Climatic characteristics

Storage and operating temperature : - 25° C to 60° C

## 6. MAINTENANCE

Clean surface with dry cloth or cloth soaked in soapy water. Do not use acetone, tar remover or trichlorethylene.

Warning : a prior test is required before using specific cleaning products.

# Plexo composable plate supports and boxes

Cat. No(s) : 696 51/56/61/68/72/78/79/80/81/83/85/87/89  
696 90/91/92/94/96/98

## 7. SPECIFIC USES

Installations with profile.

The Plexo profile distribution system provides :



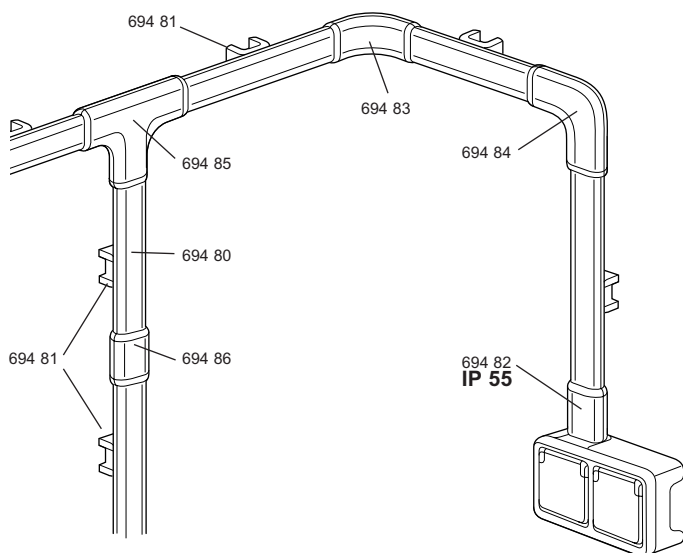

- Distribution, protection and branch connection of various wires and cables in an electrical installation.
- A profile, finishing and routing accessories (profile joint, weatherproof universal junction, flat angle, internal angle, external angle, branch connection, bracket).
- A new solution for installing weatherproof surface mounting switch-gear installations in domestic and occasionally tertiary technical situations.
- Optimum safety and reliability due to compliance with standard NFC 68-104 (IP 42, IK 07).



Cat. Nos.	Description
694 80	Plexo profile, length 2.00 m capacity equivalent to a Ø 25 mm IRL
694 81	Plexo profile bracket
694 82	<b>IP55</b> weatherproof universal connection
694 83	Plexo profile internal/external angle
694 84	Plexo profile flat angle
694 85	Plexo profile tee
694 86	Plexo universal junction

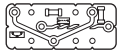
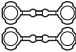
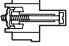
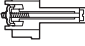

- Refer to the specific technical sheet for Plexo profile, technical sheet : F00386FR/00.

## 8. EQUIPMENT AND ACCESSORIES

Description	Uses	Cat. Nos.	Colour
Entry gland 1 entry 	Used to provide an aesthetic connection between boxes and cables up to Ø 16 mm inclusive	695 96	Grey
Entry gland 2 entries 		696 46	White
Drilling template 	Used for fast identification of mounting centre distances of all boxes	695 99 696 49	Grey White
Set of 4 covers 	Used to blank mounting holes at bottom of boxes	695 97	-
Standard claw 	Clips on to all flush mounting supports	695 98	Grey
Long claw 		849 00 849 01	
Branch connection terminal block 	Direct connection after simply stripping rigid conductors. Terminal capacity : 0.75 - 2.5 mm <sup>2</sup>	343 22	

## 9. COMPLIANCE AND APPROVALS

- Products manufactured in accordance with the following standards :
  - French NF C 61-314
  - Belgian NBN C 61-112
  - International IEC 60884-1

Quality marks	Standards	Date
	NF C 61-314	03/10/2006
	IEC 60884-1	09/03/2007

# Plexo switches and two-ways

Cat. No(s): 695 11/12/13/15/16/19/21/25/26/30/31/32/38  
696 11/12/13/15/19/25/26/27/29  
697 09/11/12/13/14/15/16/18/51/52/53/54/55/56/58  
698 11/12/17/51/52/55/56

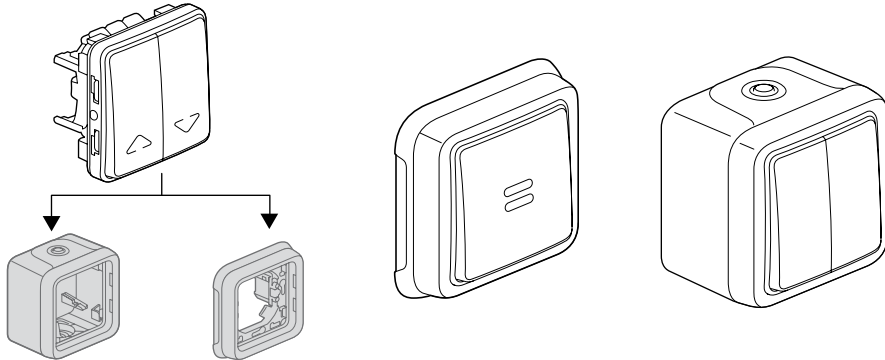

CONTENTS	Page
1. Technical data	1
2. Range	1
3. Preparation	1-2
4. Overall dimensions	3
5. General characteristics	3-4
6. Cleaning	4
7. Label holder	4
8. Double illuminated products	4
9. Equipment and accessories	4
10. Conformities and approvals	5

## 1. TECHNICAL DATA

Weatherproof wiring devices system intended for residential and professional technical premises (garages, cellars, car parks, workshops and industrial kitchens, etc.) as well as outdoor environments (patios, terraces, gardens, camping sites, etc.).  
10 AX - 250 V~ lighting control mechanisms with or without indicating (lights) or signalling (marking) components.  
All illuminated or pilot light products are supplied with their lamps fitted.  
6 AX - 250 V~ for Cat. Nos 695 15 and 696 15.

## 2. RANGE

Cat. No.	2 versions: grey and white
695 xx 696 xx	Configurable
697 xx 698 xx	Surface-mounting complete Flush-mounting complete

Designation	Marketing Cat. Nos	Characteristics	Connection
CONFIGURABLE	695 11/12/13/16/19/21/25 695 26/30/31/32/38 696 11/12/13/19 696 25/26/27/29	10 AX - 250 V~	Auto terminals
	695 15 - 696 15	6 AX - 250 V~	Auto terminals
COMPLETE	697 09/11/12/13/14/15/16/18 697 51/52/53/54/55/56/58	10 AX - 250 V~	Auto terminals
	698 11/12/17 698 51/52/55/56	10 AX - 250 V~	Auto terminals

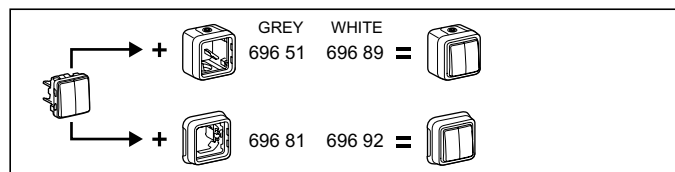

## 3. PREPARATION

### 3.1 Surface-mounting

- By screwing the base box onto the support using 2 screws Ø 3-4 mm max.
- To replace the former Plexo 55 series

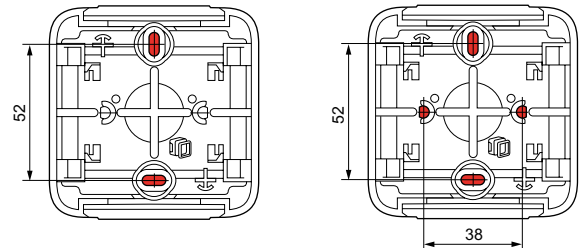

### 3.2 Flush-mounting

- frame dismantling

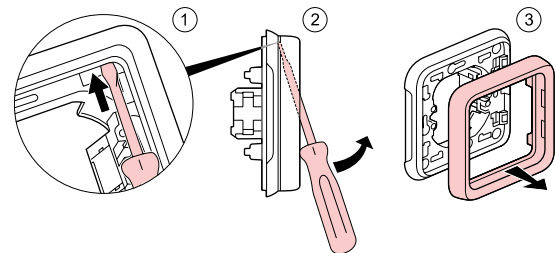

- by screwing onto a flush-mounting box
- by claws onto a flush-mounting box cat. No. 699 XX

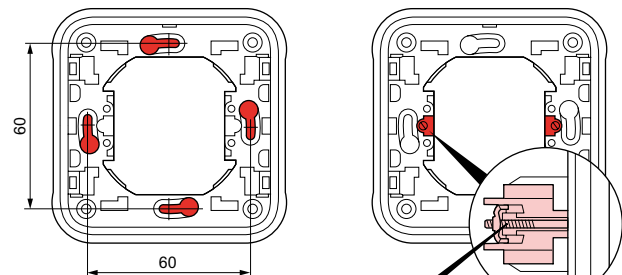

Possibility to place claws:  
Cat. No. 849 00 or  
Cat. No. 849 01 (long claw)



# Plexo switches and two-ways

Cat. No(s): 695 11/12/13/15/16/19/21/25/26/30/31/32/38  
 696 11/12/13/15/19/25/26/27/29  
 697 09/11/12/13/14/15/16/18/51/52/53/54/55/56/58  
 698 11/12/17/51/52/55/56

## 3. PREPARATION (continued)

- By face plate using 4 screws Ø 4 mm
- Piercing of support material for diameter 60-70 mm using cylinder saw or punch.

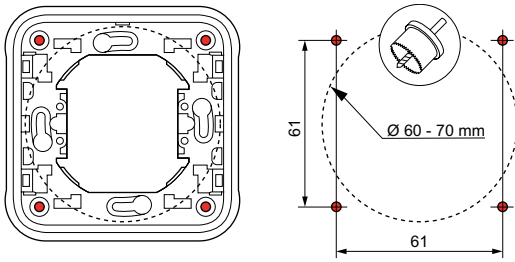

### 3.3 Connection to conductors

- Automatic terminal mechanisms

• 1 break

• 2 breaks

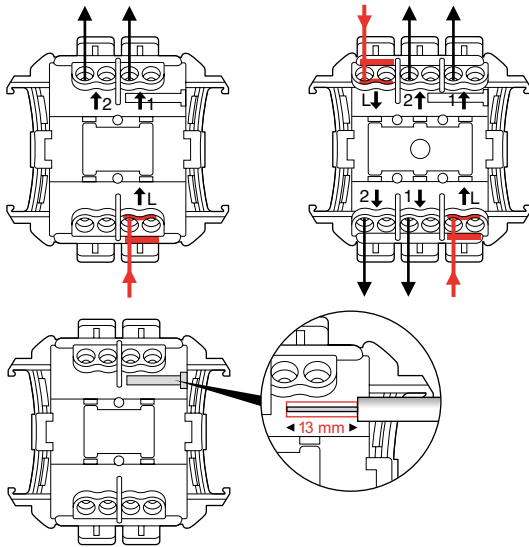

The stripping length required is 13 mm. The correct stripping length can be checked against the gauge on the rear of the base. Terminal capacity is 1.5 mm<sup>2</sup> - 2.5 mm<sup>2</sup> (1 or 2 conductors).

### 3.4 Connection to conduits

Type of conduits:

- IRL: formerly IRO, insulating rigid smooth
  - ICA: insulating bendable corrugated
  - ICTA: insulating, bendable, transversally elastic, corrugated.
  - ICTL: insulating, bendable, transversally elastic, smooth.
- Ø 16 - 25 mm

Cables (examples):

- rigid conductors: U - 1000R2V 3G2.5
- flexible conductors: H07 RN - F 3G2.5

Type of outlet glands: membrane flexible, 2 removable types.

- 1-outlet gland supplied on 1-gang box (top and bottom)
- 1-outlet gland supplied on 2 and 3-gang boxes (top)
- 2-outlet gland supplied on 2 and 3-gang boxes (bottom)

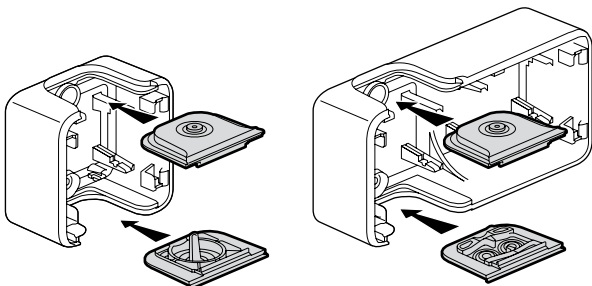

## 3. PREPARATION (continued)

### 3.4 Connection to conduits (continued)

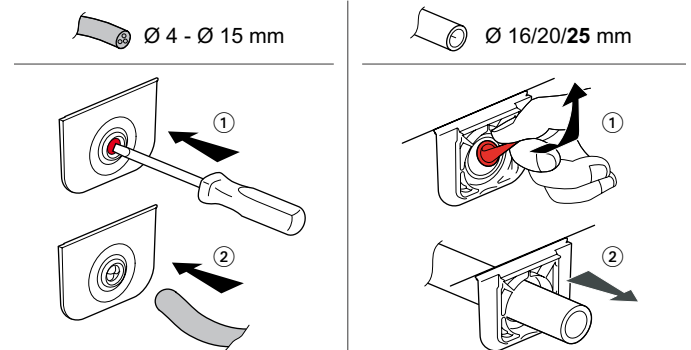

Also available as accessories:

- 695 96 1-outlet gland grey
- 695 99 2-outlet gland grey
- 696 46 1-outlet gland white
- 696 49 2-outlet gland white

### 3.5 Assembly

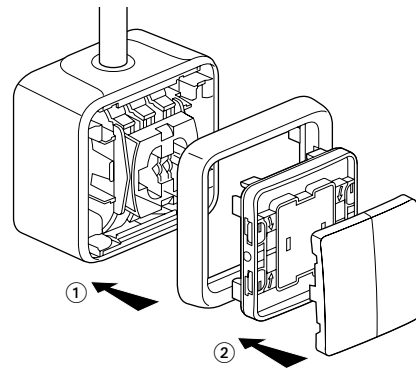

The front part (cover) is IP55 locked onto the box using four 1/4 turn screws.

The direction of rotation of each 1/4 turn screw is marked on the cover.

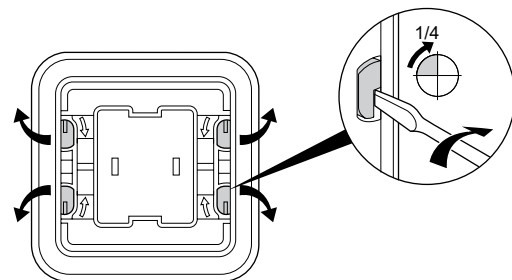

# Plexo switches and two-ways

Cat. No(s): 695 11/12/13/15/16/19/21/25/26/30/31/32/38  
 696 11/12/13/15/19/25/26/27/29  
 697 09/11/12/13/14/15/16/18/51/52/53/54/55/56/58  
 698 11/12/17/51/52/55/56

## 4. OVERALL DIMENSIONS

Configurable

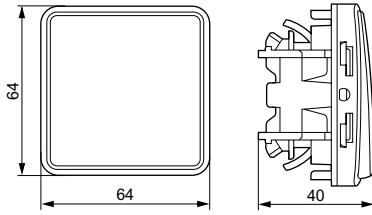

Surface-mounting

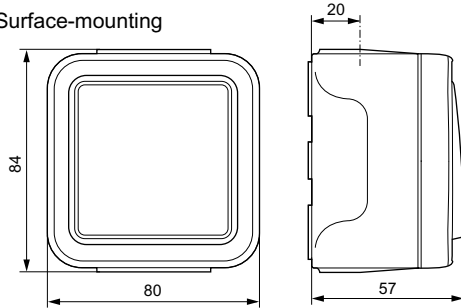

Flush-mounting

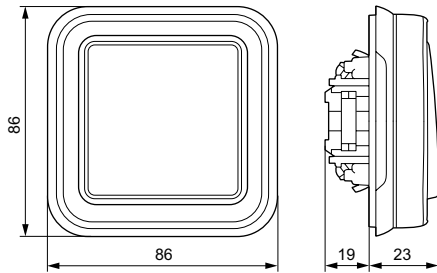

## 5. GENERAL CHARACTERISTICS

### 5.1 Mechanical characteristics

Protection index:  
 - IP 55 IK 07

### 5.2 Material characteristics

#### Materials

Box, support: PP (reinforced polypropylene)  
 Front plate, rocker: ABS (acrylonitrile butadiene styrene)  
 Entry gland, cover plate: PP+SEBS (styrene ethylene butadiene styrene)  
 Mechanism: PC (polycarbonate)

### 5.3 Resistance to chemicals

Chemical	Behaviour
Acetone	-
Acetic acid 10 %	+
Acetic acid ≥ 30 %	+
Aminosulphonic acid	-
Boric acid*	+
Bromhydric acid 47 %	-
Hydrochloric acid*	-
Chromic acid	+
Citric acid*	+
Hydrofluoric acid*	-
Formic acid	-
Lactic acid*	+
Linoleic acid	-
Maleic acid	+
Nitric acid 30 %	-
Nitric acid 50 %	-
Perchloric acid 10 %	+

Phenol-sulphonic acid	-
Phosphoric acid*	-
Sulphuric acid	+
Tannic acid*	-
Tartaric acid*	+
Ethyl alcohol	+
Isopropyl alcohol	+
Methanol	-
Phenylethyl alcohol 100 %	-
Amonia	+
Electroplating baths:	
- Bright silver bath	+
- Bright cadmium bath	+
- Chrome bath (50° C)	+
- Copper bath (with potassium cyanide)	+
- Copper bath (acid)	+
- Pickling bath with chemical copper	+
- Brass bath	+
- Bright nickel bath	+
Barium	
- Barium chloride*	+
- Barium hydroxide*	+
- Barium nitrate*	-
Benzene	-
Beer	+
Bleaching powder*	+
Cobalt chloride*	-
Copper chloride*	-
Ferrous chloride*	-
Manganese chloride	-
Mercury chloride*	-
Methylene chloride	-
Chlorine water (wet gaseous chlorine)	-
Sea water	+
Fertilizer	+
Epichlorhydrine	-
Heavy gasoline	-
White gasoline	-
Turpentine	-
Essential oils	+
Linseed oil	+
Lubricating oil	+
Machinery oil	+
Mineral oil	+
Paraffin oil	+
Fish oil	+
Castor oil	+
Silicon oil	+
Humus	+
Aqueous hydrogen sulphide	+
Sodium hypochlorite 10 %	+
Fruit juice	+
Milk	+
Chlorinated detergent	+
Margarine	+
Black oil	+
Mercury	+
Methyl methacrylate	-
Silver nitrate*	+
Cobalt nitrate*	+
Manganese nitrate*	+
Mercury nitrate*	+
Nickel nitrate*	+
Lead nitrate*	+
Petroleum, petroleum ether	-
Silicate (Potassium, Sodium)	+
Beet syrup	+
Sodium	
- Sodium acetate*	+
- Sodium bromate*	+
- Sodium chloride* (salt)	+



# Plexo switches and two-ways

Cat. No(s): 695 11/12/13/15/16/19/21/25/26/30/31/32/38  
 696 11/12/13/15/19/25/26/27/29  
 697 09/11/12/13/14/15/16/18/51/52/53/54/55/56/58  
 698 11/12/17/51/52/55/56

## 5. GENERAL CHARACTERISTICS (continued)

### 5.3 Resistance to chemicals (continued)

Caustic soda $\leq 40\%$ .....	+
Styrene monomer .....	-
Sugar .....	+
Trichloroethylene .....	-
Urine .....	+
Wine .....	+

\*All concentrations in aqueous solution.

**Interpretation: + resists - instability**

This information is given for guidance, and does not therefore engage our liability. Consult us for any special use.

### 5.4 UV resistance

No noticeable change following a 7-day test with irradiance of 550 W/m<sup>2</sup> (colorimetric measurement according to Lab method)

### 5.5 Resistance to salt spray: 7 days (168 h)

### 5.6 Electrical characteristics

- Self-extinguishing to CEI 60695-2-11:
  - components (or parts) required to hold live parts in place : 850°C
  - components (or parts) not required to hold live parts in place : 650°C
- Voltage - Current - Frequency
  - 10 AX - 250 V~ - 50 Hz suivant NF EN 60669-1, NBN EN 60669-1 et CEI 60669-1

### 5.7 Climatic characteristics

Storage and use temperature: - 25°C to + 60°C

## 6. CLEANING

Surface cleaning with dry cloth or cloth dipped in soapy water. Do not use acetone, tar remover or trichloroethylene.

Important: a test should be carried out before using any specific cleaners.

## 7. LABEL HOLDER

695 16/43/44 - 696 33/34  
 698 24/25/64/65

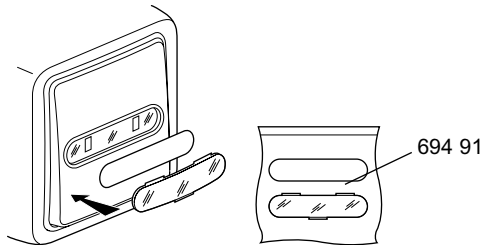





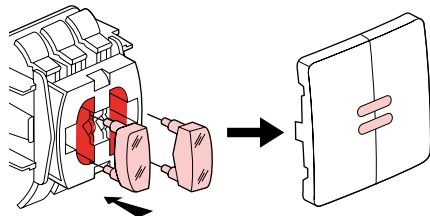





## 8. DOUBLE ILLUMINATED PRODUCTS

695 19/26 - 696 19/26

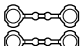
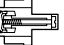
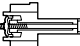

## 9. EQUIPMENT AND ACCESSORIES

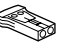

Description	Uses	Cat. No.	Colour
Label holder + label 	PVC label 30/100 <sup>th</sup> for label-holder products	694 91	
Lamp 230 V 0.5 mA fluorescent green 	Only for illuminated and basic push-button	694 96	
Lamp 230 V 0.5 mA verte fluorescente 	Indicator light	694 97	
Lamp 230 V 1 mA neon orange 	Pilot light	694 98	
Lampe 12 V 15 mA fluorescent green 	Indicator light	694 99	
Lamp 12 V 20 mA fluorescent green 	Indicator light	694 95	
1-outlet gland 	For making an aesthetic junction between boxes and cables up to Ø 16 mm inclusive	695 96 696 46	Grey White
2-outlet gland 		695 99 696 49	Grey White
Plotting template 	For rapidly finding the fixing distances of all the boxes	695 97	
Set of 4 caps 	For blanking the fixing holes at the box base	695 98	Grey
Multi-cable gland	(PG) Ø 7 - 14 mm	696 53	
Standard claw 	Mounts on all flush-mounting 1-gang supports by simple clipping	849 00	
Long claw 		849 01	
Claw 	To increase IK 07 to IK 08 for sockets and switches flush mounting items	696 47	
Tapping terminal strip 	Direct connection after simple stripping of rigid conductors Terminal capacity: 0.75 to 2.5 mm <sup>2</sup>	343 22	

# Plexo switches and two-ways

Cat. No(s): 695 11/12/13/15/16/19/21/25/26/30/31/32/38  
696 11/12/13/15/19/25/26/27/29  
697 09/11/12/13/14/15/16/18/51/52/53/54/55/56/58  
698 11/12/17/51/52/55/56

## 10. CONFORMITIES AND APPROVALS

- Products produced in compliance with standards:
  - France NF EN 60669-1
  - Belgium NBN EN 60669-1
  - International IEC 60669-1
- NF USE approval according to NF EN 60669-1

Quality marks	Standards	Cartificate N°
	NF EN 60669-1	27/11/2007
	EN 60669-1	31/05/2007