

## PVC floor duct and backboxes for concrete floor

### PVC floor duct and backboxes installation principle

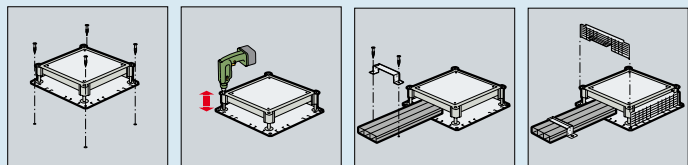

Underfloor box fixing    Height adjustment    Placing the floor ducts    Placing the lateral sides

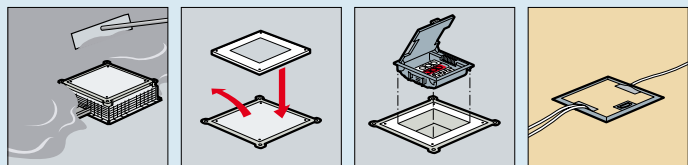

Pouring the concrete    Cover change    Placing the floor box

### Dimensions

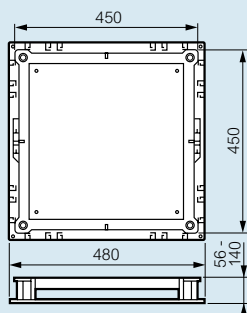

### Choice of adaptors for flush-mounting box

Floor boxes	Adaptor plates
<b>Adjustable height: 75 to 105 mm</b>	
10 modules: 0 311 80/81/82 (Easybar)	0 896 36
12 modules: 0 896 05/06/07 0 896 40/41	0 896 36
18 modules: 0 896 10/11/12 0 896 45/46	0 896 37
24 modules: 0 896 15/16/17	0 896 38
<b>Limited height: 65 mm</b>	
10 modules: 0 311 83/84/85 (Easybar) 0 896 20/21	0 896 36
16 modules: 0 896 25/26	0 896 38
<b>For heavy loads</b>	
IP 66: 0 896 85/86	0 896 83 or 0 896 84
IP 30: 0 896 88	

### PVC floor boxes and underfloor boxes installation principle

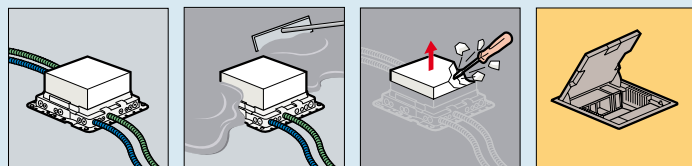

### Choice of plastic underfloor box according to the floor box to be installed

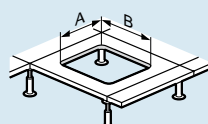
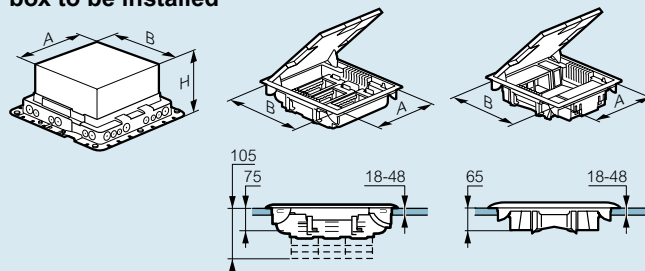

Cat.Nos	A (mm)	B (mm)
0 896 05/06/07/20/21/22	212	252
0 896 10/11/12	252	252
0 896 15/16/17/25/26/27	306	252

Floor boxes	Plastic flush-mounting box
<b>Adjustable height: 75 to 105 mm</b>	
10 modules: 0 311 80/81/82 (Easybar)	0 896 30
12 modules: 0 896 05/06/07 0 896 40/41	0 896 30
18 modules: 0 896 10/11/12 0 896 45/46	0 896 31
24 modules: 0 896 15/16/17	0 896 32
<b>Limited height: 65 mm</b>	
10 modules: 0 311 83/84/85 (Easybar) 0 896 20/21	0 896 30
16 modules: 0 896 25/26	0 896 32

### Floor boxes for heavy loads

#### Size

Cat.No 0 896 86

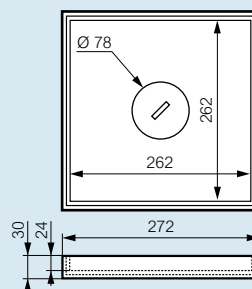

Cat.No 0 896 85

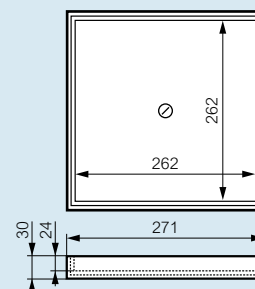

## metal and plastic backboxes for concrete floor

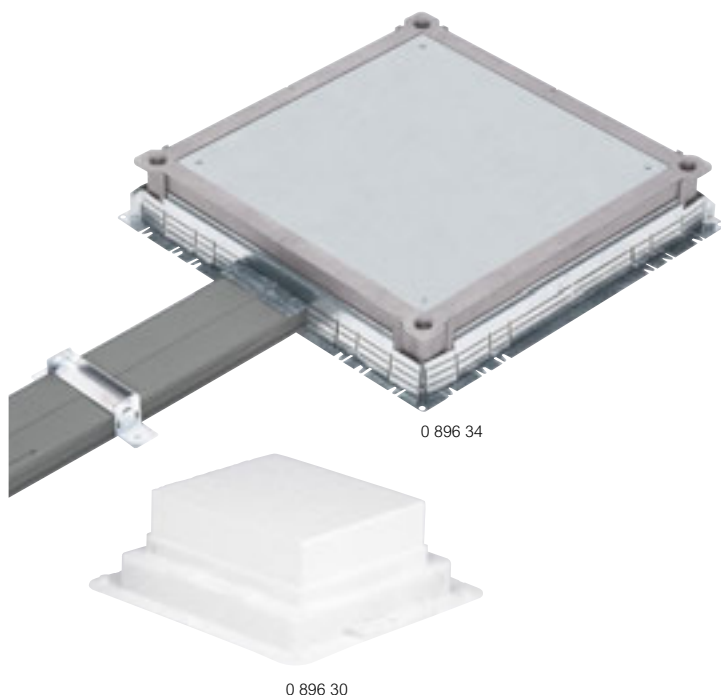

## PVC floor duct for concrete floor

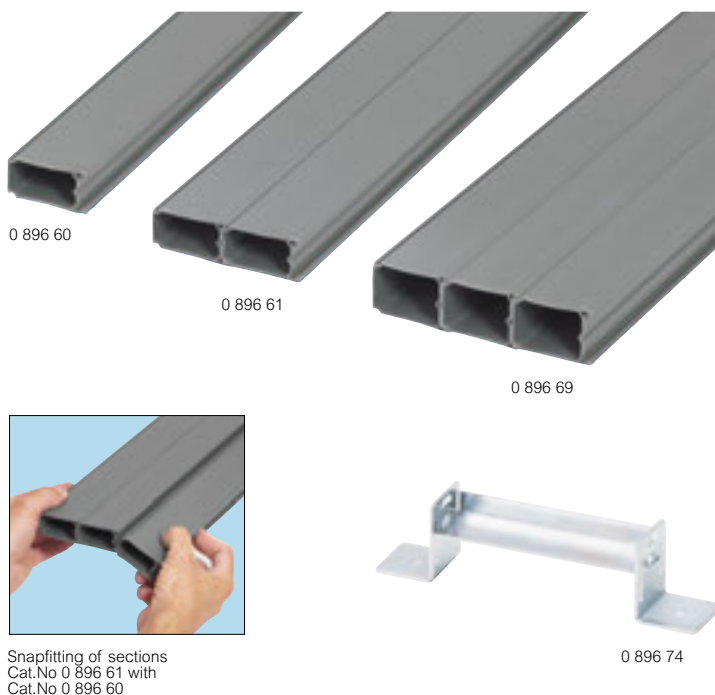

Pack	Cat.Nos	<b>Adjustable metal backbox for concrete floor</b>
		<b>Universal backbox</b> For junction of LV and ELV cabling and/or installation of floor boxes Height adjustable from 56 mm to 140 mm using 4 screws located in the box corners and a tool adapting to electric drill or screwdriver Bendable side walls for joining with different sizes of floor ducts Supplied with worksite protection cover to be replaced by blanking cover plate or mounting cover plate
1	0 896 34	Universal metal in-screed backbox
		<b>Cover plates</b> Thickness 3 mm
5	0 896 35	Blanking cover plates for simple junction
5	0 896 36	Adaptor plate for floor boxes 12 modules, or floor boxes of reduced height 10 modules
5	0 896 37	Adaptor plate for floor boxes 18 modules
5	0 896 38	Adaptor plate for floor boxes 24 modules, or floor boxes of reduced height 16 modules
		<b>Auto-adjustable plastic backboxes for concrete floor</b> For integration of floor boxes in in-screed floor installations Power supply by flexible conduits Ø16, 20 and 25 mm Supplied with polystyrene for easy installation
1	0 896 30	For integration of 12 modules floor boxes or 10 modules reduced height floor boxes
1	0 896 31	For integration of 18 modules floor boxes
1	0 896 32	For integration of 24 modules floor boxes or 16 modules reduced height floor boxes

Pack	Cat.Nos	<b>PVC floor duct</b>
		IP 40 - IK 08 For distributing LV and ELV cabling in concrete floor installations Combines with metal backbox for cable junction or floor box installation Length: 2 m Can be assembled to make the number of compartments required (for immediate use or standby)
		<b>Height 28 mm</b>
16	0 896 60 <sup>1</sup>	50 x 28 mm with 1 compartment
12	0 896 61 <sup>1</sup>	100 x 28 mm with 2 compartments
14	0 896 62 <sup>1</sup>	150 x 28 mm with 3 compartments
6	0 896 63 <sup>1</sup>	200 x 28 mm with 4 compartments
		<b>Height 38 mm</b>
12	0 896 67 <sup>1</sup>	50 x 38 mm with 1 compartment
16	0 896 68 <sup>1</sup>	100 x 38 mm with 2 compartments
10	0 896 69 <sup>1</sup>	150 x 38 mm with 3 compartments
8	0 896 70 <sup>1</sup>	200 x 38 mm with 4 compartments
		<b>Fixing / coupling accessories</b> For fixing floor ducts on floor and junction between ducts
5	0 896 74	For duct width 100 mm
5	0 896 75	For duct width 150 mm
5	0 896 76	For duct width 200 mm
5	0 896 77	For duct width 250 mm
5	0 896 78	For duct width 300 mm

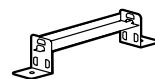

1: Number of metres contained in pack